

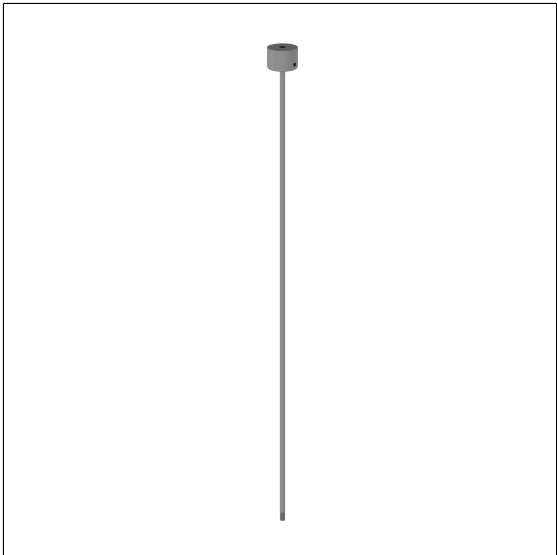

Care Solutions • Inox Care

Inox Care Ceiling support  
Article number: 2065310009

Product image



Technical specifications

Product group	5600
Product	Ceiling support
Length	500 mm
Material	stainless steel, material No. 1.4301 (A2, AISI 304)
Surface	brushed finish
Diameter	6 mm
Colour	available in Mirror polished (008) and Satin (009)

Technical drawing

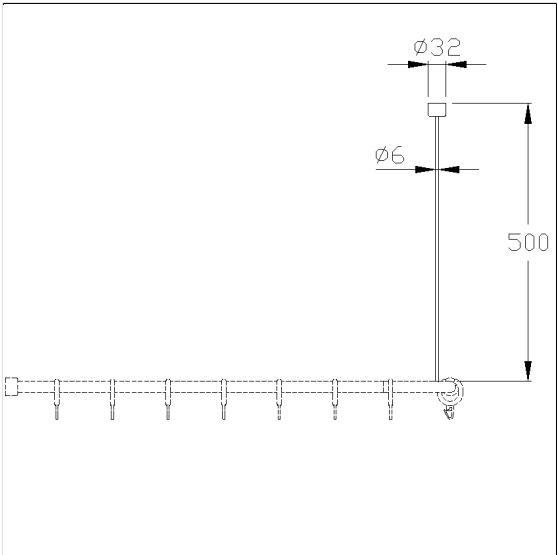

Product description

- Inox Care is a durable and versatile stainless steel range that combines accessibility and hygiene in a modern design
- for Inox Care Shower curtain rails
- can be shortened (length)
- for fixing on connection thread of the shower curtain rail
- ceiling support with axial fixing screw
- In case of lightweight partition walls a backfill made of min. 20mm hardwood is needed
- Ceiling support for suspended ceiling upon request
- supplied with stainless steel Torx screw sØ 6 x 70 mm and plugs

