

Inox Care Lift-up shower seat,  
with hygiene recess

Article number: 2974030008

### Product image



### Technical specifications

Product group	5500
Product	Lift-up shower seat, with hygiene recess
Length	450 mm
Height	450 mm
Width	100 mm
Material	stainless steel, material No. 1.4301 (A2, AISI 304), padded made of PUR integral foam
Surface	high gloss
Colour	available in Mirror polished (008) and Satin (009), padded, colour black
Loading	max. 175 kgs

### Technical drawing

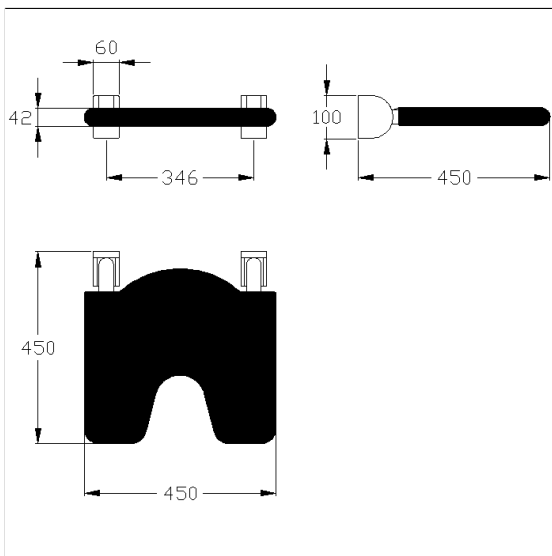

### Product description

- Inox Care is a durable and versatile stainless steel range that combines accessibility and hygiene in a modern design
- Pad with non-corrosive steel core throughout
- steel reinforced hinges
- lateral covers in stainless steel look
- with adjustable brake
- locked in place in vertical position
- concealed screw fixing
- In case of lightweight partition walls a backfill made of min. 20mm hardwood is needed
- load capacity: max. 175kgs according to ISO17966:2016, statically tested up to 200kgs
- Fixing set has to be determined according to conditions on site, is to be ordered separately

