

Care Solutions · Nylon Partition solutions

Nylon Support foot,
with floor anchor

Article number: 0289030018

Product image



Technical specifications

Product group	2600
Product	Support foot, with floor anchor
Short name	NY.STF 95.10
Length	70 mm
Width	70 mm
Height	250 mm
Material	polyamide
Surface	high gloss
Colour	available in nylon colours

Technical drawing

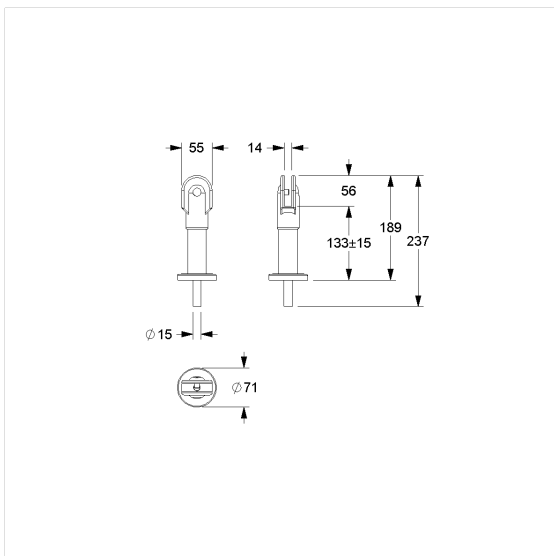

Product description

- Design partition solutions for doors and partitions made of HPL board material
- for panel thickness 13 mm, can also be used for panel thickness 10 mm with spacer 0289620
- consisting of plate holding part, tube, rosette top \varnothing 70 mm and base
- height adjustable +/- 15 mm
- Supplied with threaded bush, a cap and a 5 x 20mm screw for panel fixing
- The mounting set for floor mounting must be ordered separately
- Support foot without tube is also suitable as an installation aid, the height of the partition wall panels can be adjusted effortlessly

