



Care Solutions

Nylon Care Adapter set,
intermediate plates

Article number: 0300367018

Product image



Technical specifications

Product group	0700
Product	Adapter set, intermediate plates
Length	12 mm
Width	155 mm
Height	227 mm
Material	stainless steel, material No. 1.4301 (A2, AISI 304)
Surface	scratch-resistant powder coating
Colour	available in colours Black (016), Dark grey (018), White (019) and Manhattan (067)

Technical drawing

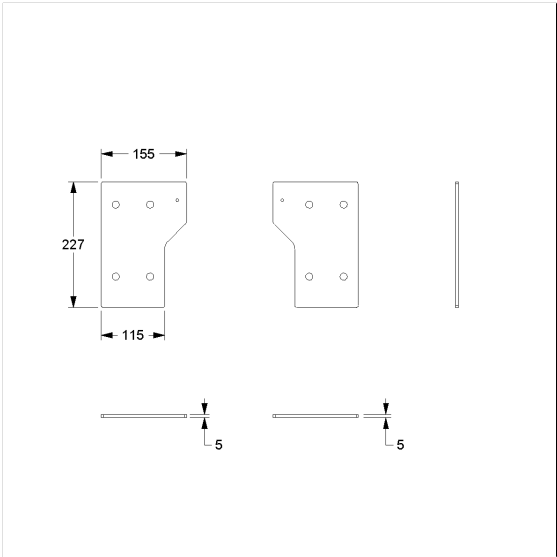

Product description

- Nylon Care - a well-tried and proven product family with a wide range of variants, three product series suiting many different requirements
- for attachment to two lift-up support tails or for mounting on one lift-up support rail and on the wall
- for attaching the adjustable backrest directly to the lift-up support rail
- concealed screw fixing
- for wall mounting above WC in accordance with DIN 18040-1/ONORM B1600
- supplied with M6 countersunk screws for fixing to the intermediate plates on both sides

