



Care Solutions

Inox Care Adapter set,
intermediate plates

Article number: 2050537009

Product image

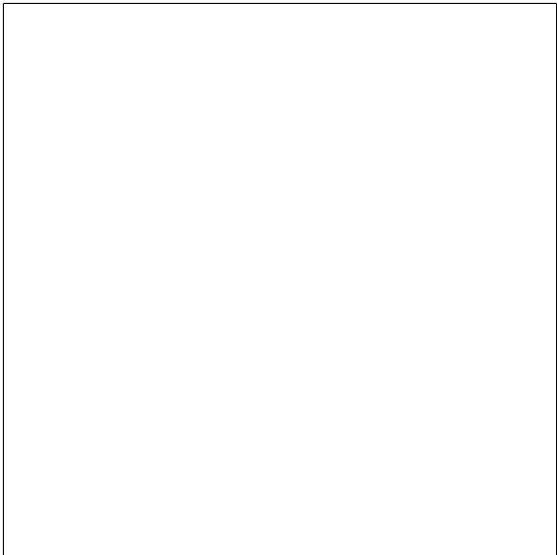

Technical specifications

Product group	5500
Product	Adapter set, intermediate plates
Length	12 mm
Width	155 mm
Height	227 mm
Material	stainless steel, material No. 1.4301 (A2, AISI 304)
Surface	satin
Colour	Satin (009)

Technical drawing

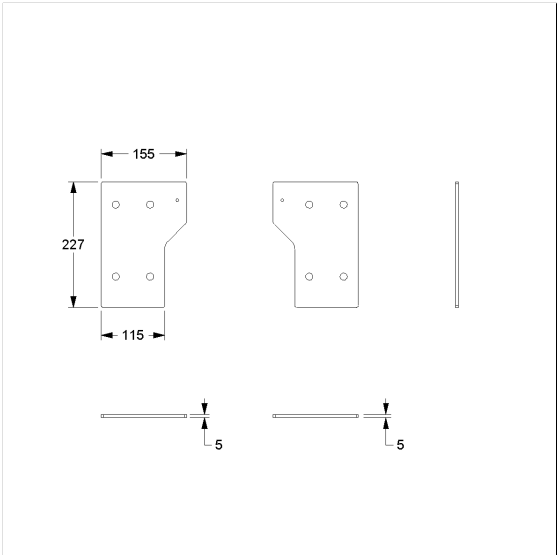

Product description

- Inox Care is a durable and versatile stainless steel range that combines accessibility and hygiene in a modern design
- for attachment to two lift-up support tails or for mounting on one lift-up support rail and on the wall
- for attaching the adjustable backrest directly to the lift-up support rail
- concealed screw fixing
- for wall mounting above WC in accordance with DIN 18040-1/ONORM B1600
- supplied with M6 countersunk screws for fixing to the intermediate plates on both sides



009